



Burdell, Qld
11 Rowley Place

4 BED
2 BATH
2 CAR

keyes&co.
PROPERTY

What a Surprise!

Located in the popular suburb of Burdell this roomy family home that accommodates all the family's needs. With a fantastic entertaining area ready for a BBQ this is a fantastic property option.

The Property

- Light-filled open plan living and dining area
- Separate media room offering living area separation
- 4 generous bedrooms all with built-ins, air-conditioning and security
- Main bedroom with private access to the patio, walk through robe and ensuite
- Separate office to the front of the home as well (could be a 5th bedroom)
- Central kitchen with oversized walk-in pantry and practical servery to the patio

SOLD

Contact: Tess Sellwood
0439 793 559

Type: House

Sold Date: 12/10/2020

Land: 512m2

<https://www.keyesandco.com.au>

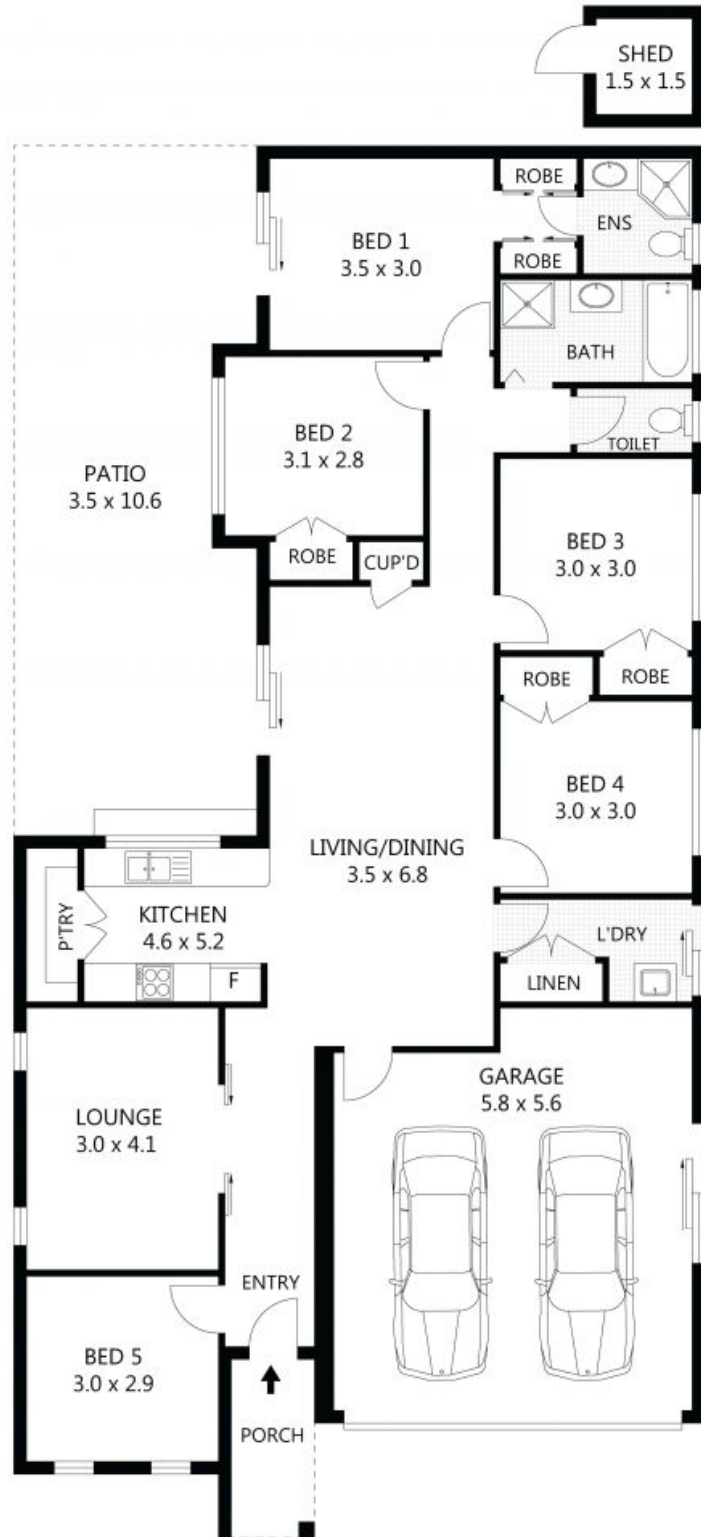

Scale in metres. Indicative only. Dimensions are approximate. All information contained herein is gathered from sources we believe to be reliable. However we cannot guarantee its accuracy and interested parties should rely on their own enquiries.

TOTAL UNDER ROOF	-	206m ²
RESIDENCE	-	130m ²
PATIO	-	39m ²
GARAGE	-	33m ²
PORCH	-	4m ²

11 Rowley Place, Burdell

Plans shown are only indicative of layout. Dimensions are approximate.

Burdell, Qld
11 Rowley Place