



Condon, QLD

19 Chelsea Drive

5
BED

3
BATH

4
CAR

keyes&co.
PROPERTY

A Very Rare Opportunity in Chelsea Place

It's not too often that the opportunity comes along to purchase one of the finest properties in Chelsea Place.

This magnificent home has been designed with fine living and entertaining in mind. There are 5 genuine living areas and two large outdoor entertaining areas – both overlook the secluded and very private in ground pool. The Indoor living area's are all located adjacent to the centrally positioned kitchen. The kitchen is the centre piece of the home with stainless steel appliances, stone bench tops and a large walk in pantry.

Quality, quality, quality is this homes signature, with 2.7m high ceilings, full air-conditioning, fine fittings and fixtures, and speakers to outdoor entertaining areas controlled from the home theatre.

SOLD

Contact:

Type: House

Sold Date: 08/12/2016

Land: 2000m2

<https://www.keyesandco.com.au>

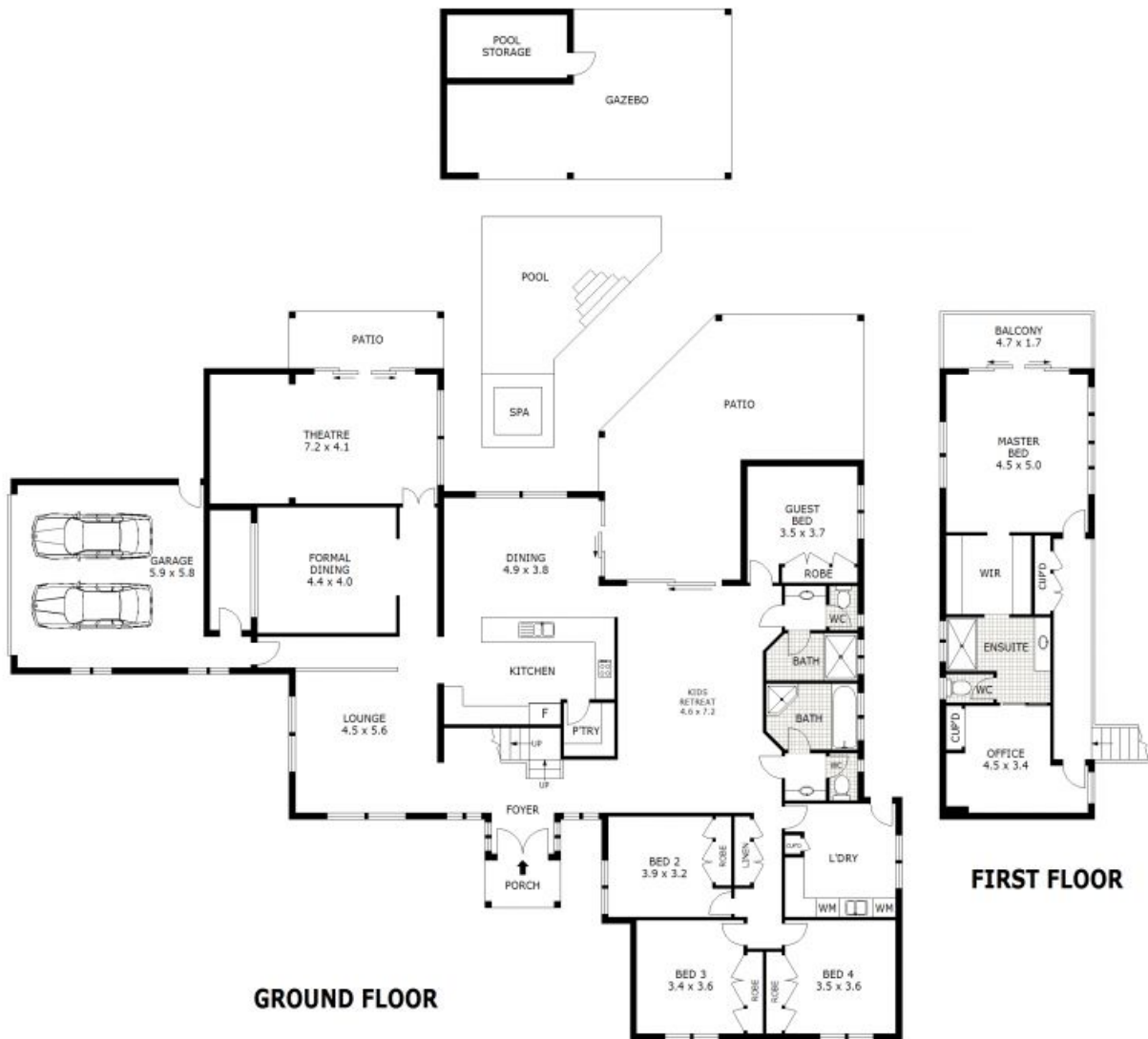

GROUND FLOOR

FIRST FLOOR



Scale in metres. Indicative only. Dimensions are approximate. All information contained herein is gathered from sources we believe to be reliable. However we cannot guarantee its accuracy and interested parties should rely on their own enquiries.

Ground Floor	-	273 m ²
First Floor	-	65 m ²
Garage	-	36 m ²
Patio	-	58 m ²
Porch	-	4 m ²
Balcony	-	8 m ²
Gazebo	-	39 m ²
Storage	-	8 m ²

19 Chelsea Drive, Condon

Plans shown are only indicative of layout. Dimensions are approximate.

Condon, QLD
19 Chelsea Drive