



## Douglas, QLD

2 Boston Crescent

**4**  
BED

**2**  
BATH

**2**  
CAR

**keyes&co.**  
PROPERTY

### Price Reduced, Must Sell!

Spread over a generous 775m<sup>2</sup> corner allotment this contemporary home offers a readymade modern lifestyle with generously proportioned living areas. The relaxed outdoor entertaining & in-ground pool makes this an exceptional mid entry point into this very popular area within minutes of the Townsville hospital, James Cook university, Stockland and Myer only just down the road.

#### The Property

- Versatile layout with three separate living areas and outdoor flow
- 2.7m high ceilings throughout
- Central kitchen with large, chef's gas cook top
- Very practical kitchen also includes servery window to patio

### SOLD

**Contact:** Damien Keyes  
0418 781 421

**Type:** House

**Sold Date:** 17/02/2014

**Land:** 775m<sup>2</sup>

<https://www.keyesandco.com.au>

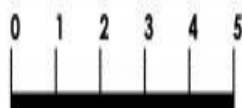
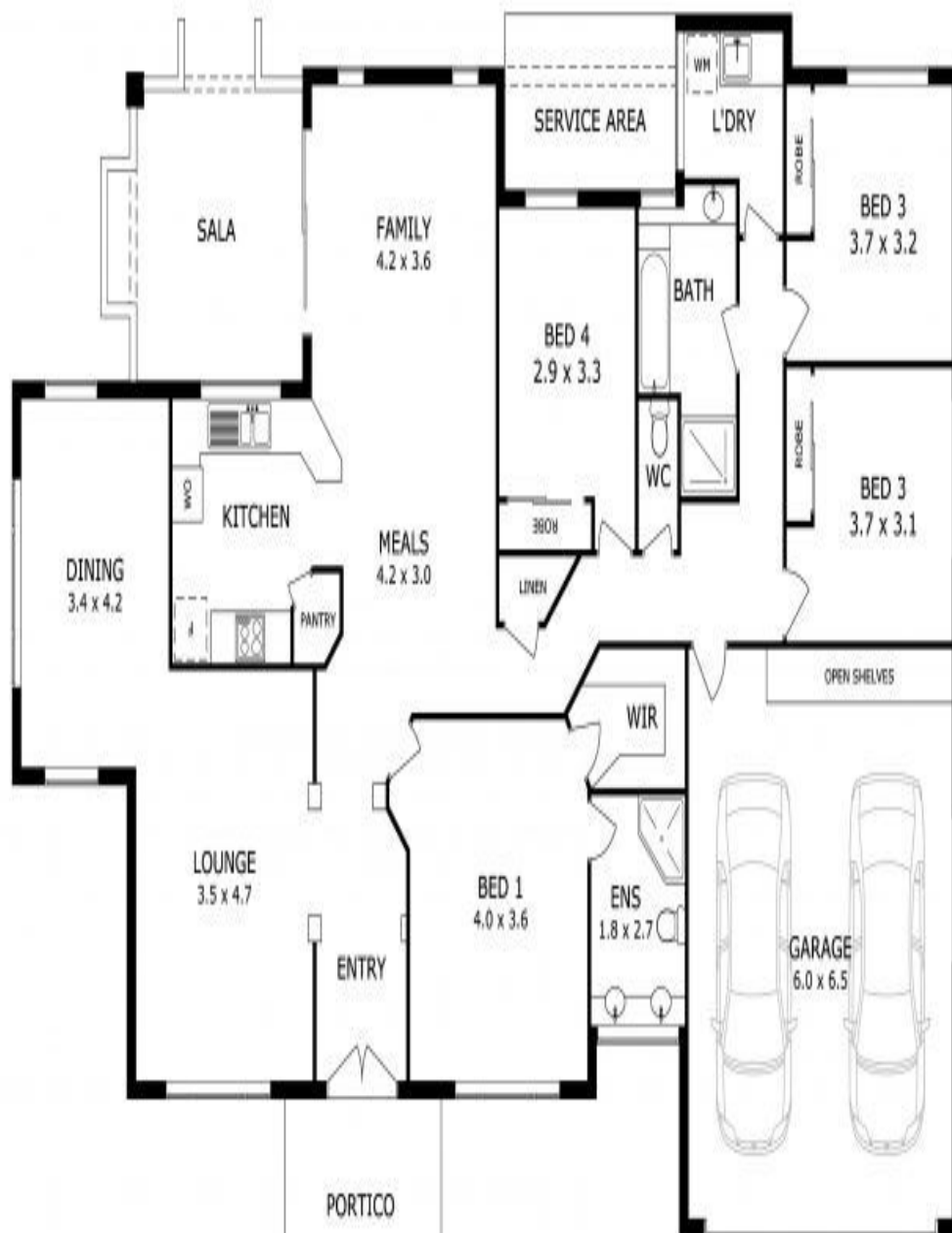

Scale in metres. Indicate only. Dimensions area approximate. All information contained herein is gathered from sources we believe to be reliable. However we cannot guarantee its accuracy and interested person should rely on their own enquiries

Living	- 182.63 m <sup>2</sup>
Portico	- 8.64 m <sup>2</sup>
Garage	- 42.16 m <sup>2</sup>
Sala	- 16.30 m <sup>2</sup>
Service Area	- 7.60 m <sup>2</sup>
Total	- 257.33 m <sup>2</sup>



## 2 Boston Crescent, Douglas

Plans shown are only indicative of layout. Dimensions are approximate.

**Douglas, QLD**  
2 Boston Crescent