



Annandale, QLD
103 Marabou Drive

4 BED
3 BATH
2 CAR

keyes&co.
PROPERTY

Sold Under The Hammer!!!!

One of the most successful formulas for wealth creation is buying real estate in prime locations and in particular, properties located on absolute waterfront. Marabou Drive is one such location occupying one of the most picturesque stretches of the Ross River and offering residents unrivalled river and park views. This stately residence constructed by its original owners and tightly held for the past 20 years is now coming to market with the current owners having raised their family there and now seeking a change to suit their stage in life.

Auction: Tue, 10 Dec 2013 @ 6:00pm

Contact: Damien Keyes
0418 781 421

Type: House
Sold Date: 10/12/2013

Land: 750m2
<https://www.keyesandco.com.au>

The Property

- Stately proportions at approx. 437m2 under roof

Ground Floor

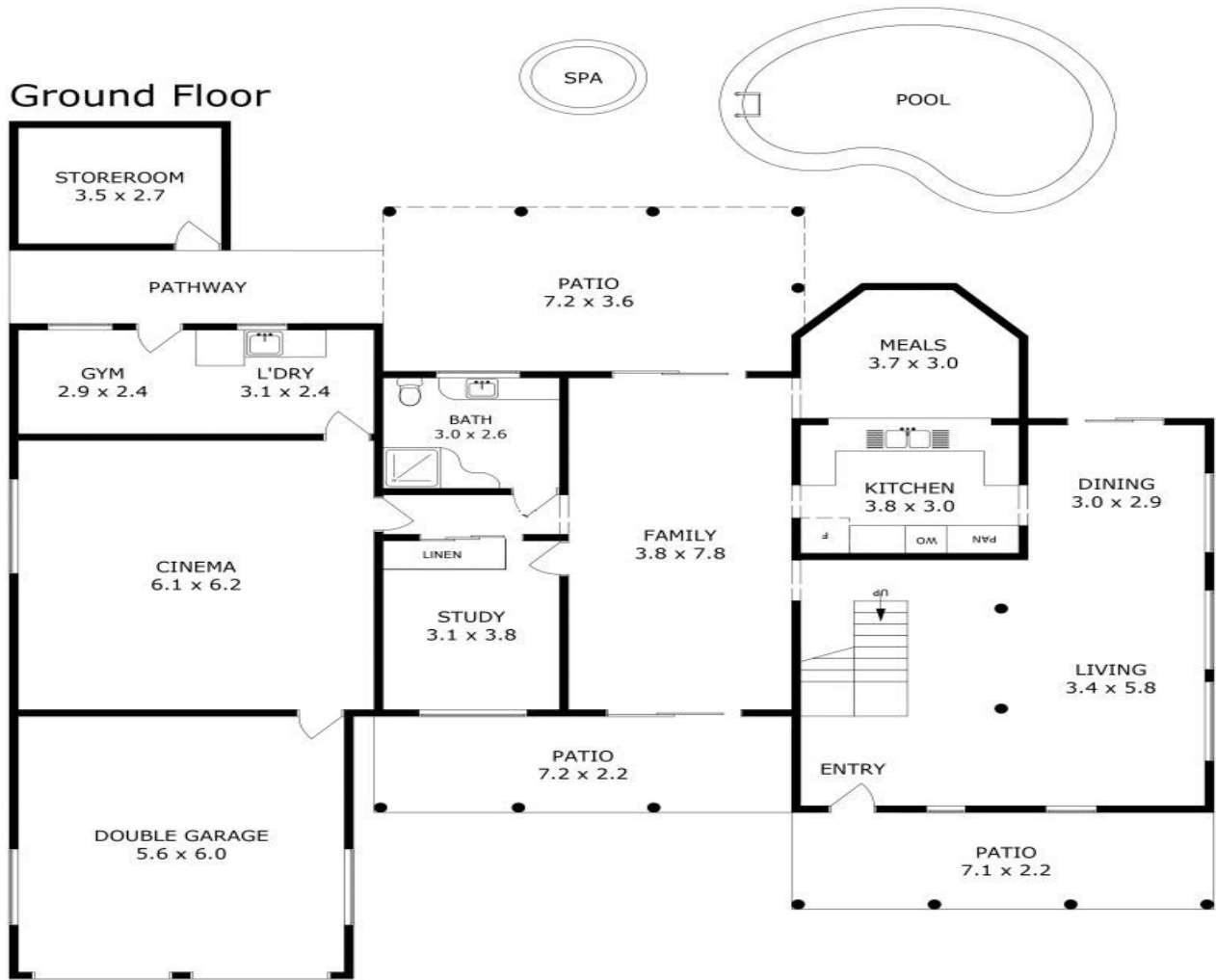

First Floor

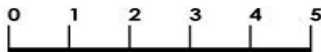

Scale in metres. Indicate only. Dimensions area approximate. All information contained herein is gathered from sources we believe to be reliable. However we cannot guarantee its accuracy and interested person should rely on their own enquiries

Ground - 217.02 m²
 First - 139.13 m²
 Garage - 36.35 m²
 Patio - 25.92 m²
 Store - 19.38 m²



103 Marabou Drive, Annandale

Plans shown are only indicative of layout. Dimensions are approximate.

Annandale, QLD
 103 Marabou Drive